



# Floor Solutions

## PAVAFLOOR THERMAL / System description:

NBT Pavafloor Thermal System is a thermal insulation system for solid floors where a solid wood or dry fix tile system is specified.

Woodfibre boards have particularly good health and environmental benefits, helping to control internal moisture levels, being entirely non toxic, and also locking up carbon in their use.

There are a number of other ways of using NBT Pavatex woodfibre boards in thermal flooring systems. Please contact NBT for further details.

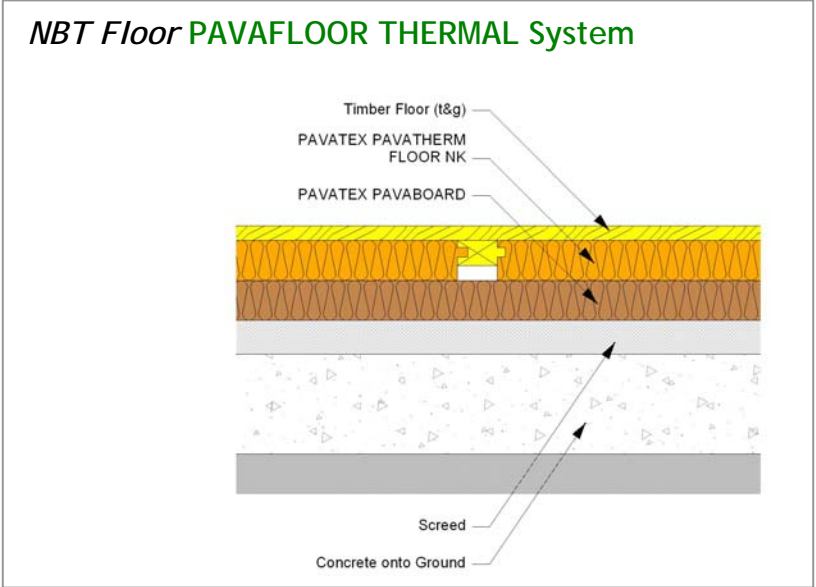

### *System Application:*

NBT Pavafloor Thermal System can be used on any solid floor which is dry and protected from damp or other water ingress. It is important that new oversites and screeds are fully dried before application. Please contact NBT for more details.



### *System Benefits:*

- Good thermal performance, with reduced cold bridging by design
- Simple dry system
- Fully ecological products
- Design calculations and detailing from NBT
- Site support and training as required
- Tried and tested system

### *Environmental Performance:*

NBT Pavatex woodfibre boards are 95% waste wood from sustainable forests. They are entirely non toxic, lock up carbon in use, and are fully environmentally audited and certified.



# Floor Solutions

## Technical details: Thermal values

### Solid Concrete with Timber Floor Finish 22mm

Insulation Layer ①	40mm Pavatherm Floor NK	60mm Pavatherm Floor NK	40mm Pavatherm Floor NK	60mm Pavatherm Floor NK	40mm Pavatherm Floor NK	60mm Pavatherm Floor NK
Insulation Layer ②	none	none	40mm Pavaboard	40mm Pavaboard	60mm Pavaboard	60mm Pavaboard
U-Value* [W/m²K]	0.40	0.34	0.29	0.26	0.26	0.23
Construction Height [mm]	62	82	102	122	122	142
Point Load [kN]	1.0	1.0	1.0	1.0	1.0	1.0
General Load [kN/m²]	2.0	2.0	2.0	2.0	2.0	2.0

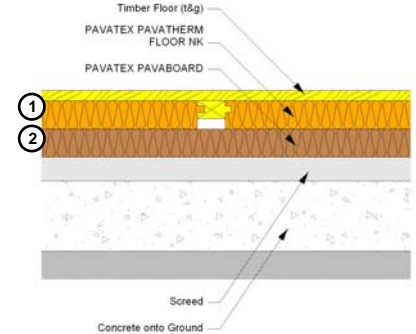

### Solid Concrete with Screed Replacement Tile (SRT) Finish 20mm

Insulation Layer ①	20mm Pavaboard	40mm Pavaboard	60mm Pavaboard	40mm Pavaboard	60mm Pavaboard	60mm Pavaboard
Insulation Layer ②	none	none	none	40mm Pavaboard	40mm Pavaboard	60mm Pavaboard
U-Value* [W/m²K]	0.52	0.42	0.35	0.30	0.26	0.24
Construction Height [mm]	40	60	80	100	120	140
Point Load [kN]	3.0	2.0	1.5	1.5	1.5	1.0
General Load [kN/m²]	3.0	2.0	2.0	2.0	2.0	2.0

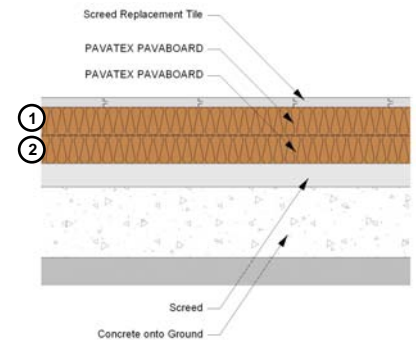

\*7m x 7m with P/A 0.57

## Full System Components:

**Insulation boards:** Interlocking Pavatherm Floor NK (40,60mm), and square edged high density Pavaboard boards (20,40,60mm).

**Timber battens:** Interlocking timber battens for the Pavatherm Floor NK system. These battens are held suspended by the woodfibre boards, to reduce the cold bridging through this element. In acoustic floors it also reduces impact sound transmission.

**Screed replacement tiles:** NBT work with suppliers of SRT systems. Please contact NBT for further details

## NBT Support:

**Design support:** Full design support including assistance with detailing, thermal and other calculations

**Training:** either at NBT or on site for applicators, site managers etc

**Site Support:** NBT will assist on site, giving advice on technical, application and quality issues.

