



## Project Description and Aims

Hastings Creative Media Centre is part of a government funded, regeneration programme for Hastings and Bexhill which was designed as a hub for Hastings' thriving creative scene. The building was designed by BBM Sustainable Design who wanted it to be a landmark building for the town and project an image of a dynamic, forward-thinking community. The design objectives were to incorporate high performance sustainable products wherever the design brief allowed and to ensure that the building would be a low energy, healthy and comfortable place to work.



## NBT role in project

NBT provided design support and calculations to the architect at various stages of the project. Technical support was given to the contractor as work progressed on site.

# Hastings Creative Media Centre

Client: SEEDA (South East England Development Agency)

Architect: BBM Sustainable Design Ltd

Contractor: ROK Ltd, Crawley, West Sussex

Contract Value: £3M

### Performance:

The walls were designed with a U-value of 0.21W/m2K. This was achieved using Diffutherm 80mm Woodfibre board onto a 100mm timber frame with Sheepswool insulation between the timber stud-work. The Diffutherm boards were rendered with a lime based render first coat, then finished with a decorative coloured top-coat onto which an equalising paint was used to give a high quality finished appearance.



### Buildability:

Diffutherm boards are available in three thicknesses (60mm 80mm and 100mm) and are interlocking on all four sides. They are quick and easy to install and eliminate the need for membranes and vapour checks. They provide enhanced thermal and acoustic insulation; airtightness; heat loss and overheating control and can be used as a render carrier. The boards when used in conjunction with a lime based render provide a highly "vapour open" construction which actively controls the level of moisture within the building's fabric. This in turn helps to ensure a healthy internal working environment for the building's occupants. The BaumitBayosan MC55W lime based mineral render is designed specifically for use on Woodfibre boards and is highly vapour open and can be applied by hand or machine.

### Environmental:

Diffutherm boards have an excellent ecological profile and are manufactured from 99.5% waste pinewood and 0.5% paraffin (to provide weather resistance during construction) and contain no artificial glues, resins or wood preservers. The boards are non toxic or irritant and contain no substances which can off-gas. The boards will compost naturally and therefore require no special precautions to be taken on final disposal. The Lime based renders are ecological and have minimum environmental impact.

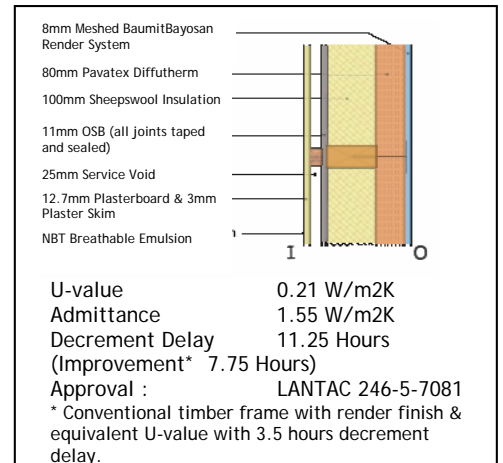

### Design Issues:

From Architect: This was a high profile project in respect of sustainability and as well as the wall construction, which was unusual for a commercial building, other features such as triple glazed windows and passive solar collection on the south facing aspect of the structure ensured that a minimum amount of energy would be required to heat the building during the colder months. The mineral render gave a very sharp and pleasing external finish.

### Build Issues:

From Contractor: The technical support from NBT's staff on site was good but there were difficulties with the approved rendering sub-contractor who took much longer to complete the work than expected due to a shortage of labour being provided on site. In spite of this it was a project which we, as the contractors, were pleased to have been associated with.



Project images ©BBM Sustainable Design Ltd

"The Science of Nature—The future of Construction"

Natural Building Technologies Ltd

The Hangar, Worminghall Road, Oakley Bucks. HP18 9UL

Tel: 01844 338338 Fax: 01844 338525 Email: info@natural-building.co.uk Website: natural-building.co.uk